

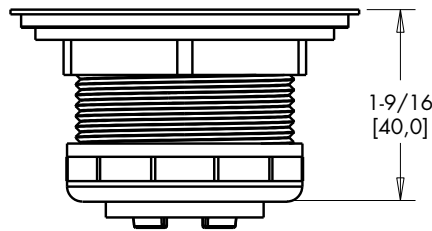

SERVING YOU SINCE 1926

KASON FOOD SERVICE 31-A AMLAJACK BLVD. NEWNAN, GA 30265
1-800-935-2766 WWW.KASONIND.COM

APPLICATION:	
JOB NAME:	
QUANTITY:	SPECIFIER NO:

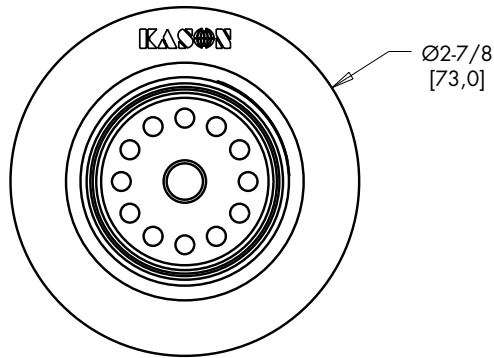
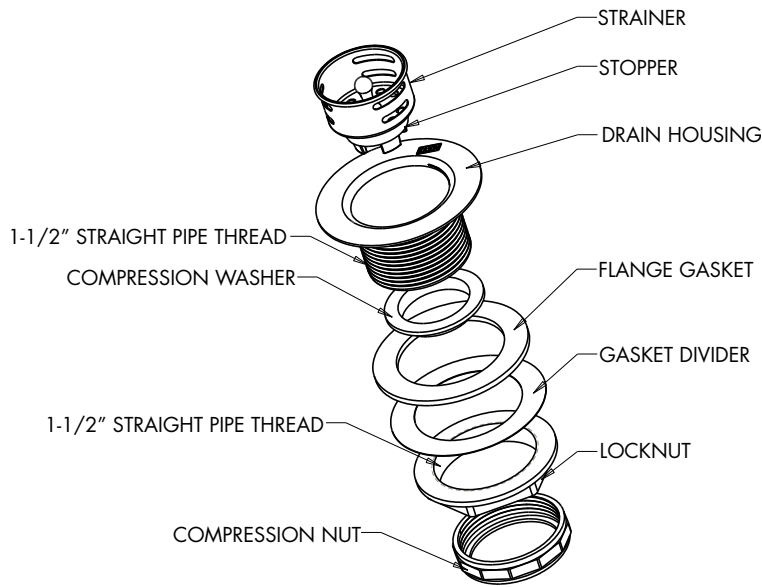

PRODUCT NAME: MINI BASKET DRAIN

SPECIAL CONFIGURATION
CHECK BASE MODEL AND OPTIONS

MODEL:

<input type="checkbox"/> 463-2004	MINI BASKET DRAIN
<input type="checkbox"/> 463-2002	CRUMB CUP
<input type="checkbox"/> 463-2003	MINI BASKET DRAIN W/O CRUMB CUP

OPTIONS OR MODIFICATIONS:

<input type="checkbox"/> TAILPIECE
<input type="checkbox"/> OVERFLOW TUBES
<input type="checkbox"/> BRASS LOCKNUT

FEATURES:

- *STAINLESS STEEL CONSTRUCTION.
- *COMBINATION REMOVABLE CRUMB CUP AND STOPPER.

MATERIALS:

- *HIGHLY POLISHED #400 STAINLESS STEEL STRAINER AND DRAIN HOUSING.
- *RUBBER STOPPER AND FLANGE GASKET.
- *DIE-CAST ZINC COMPRESSION NUT AND LOCK NUT.
- *POLYPROPYLENE COMPRESSION WASHER.

APPROVALS:

DATE:



SERVING YOU SINCE 1926

KASON FOOD SERVICE 31-A AMLAJACK BLVD. NEWNAN, GA 30265
1-800-935-2766 WWW.KASONIND.COM

APPLICATION:	
JOB NAME:	
QUANTITY:	SPECIFIER NO:

PRODUCT NAME: DUO BASKET DRAIN

SPECIAL CONFIGURATION
CHECK BASE MODEL AND OPTIONS

MODEL:
 463-2008 DUO BASKET DRAIN

OPTIONS OR MODIFICATIONS:

TAILPIECE
 OVERFLOW TUBES
 BRASS LOCKNUT

FEATURES:
 *STAINLESS STEEL CONSTRUCTION.
 *COMBINATION REMOVABLE CRUMB CUP AND STOPPER.

MATERIALS:
 *HIGHLY POLISHED #400 STAINLESS STEEL STRAINER AND DRAIN HOUSING.
 *RUBBER STOPPER AND FLANGE GASKET.
 *DIE-CAST ZINC STEM, COMPRESSION NUT, AND LOCK NUT.
 *POLYPROPYLENE COMPRESSION WASHER.

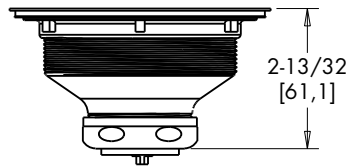
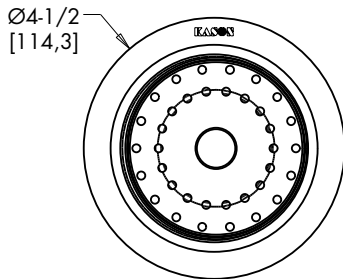
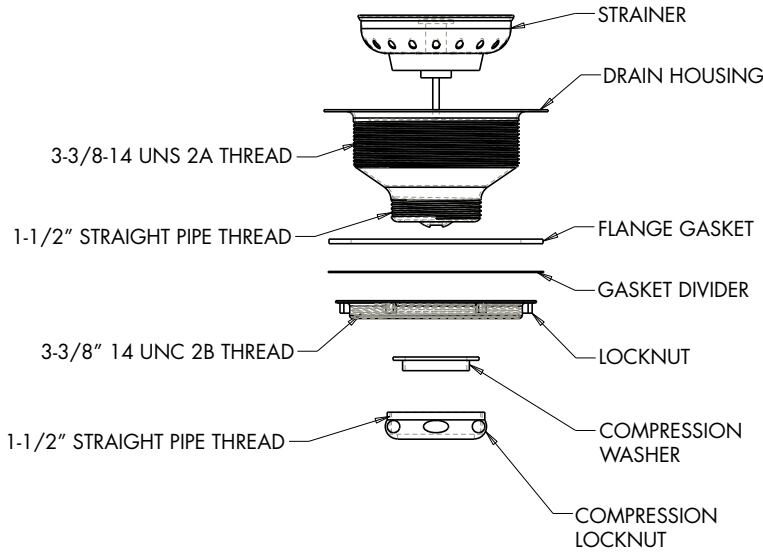

APPROVALS:	
DATE:	